



JIN GONG

HEBEI JINGONG
MACHINERY CO., LTD



Professional hoisting equipment manufacturer
Advanced lifting solution supplier
Comprehensive sales service



PERMANENT MAGNETIC LIFTER

JG



Manual

Permanent Magnetic Lifter

- No power operation
- Professional modeling design
- High to three times of the rated load
- V groove for respective round steel and plate
- Qualified magnetic circuit design, zero remanence
- Nd-Fe-B reliable material with higher lifting capacity and permanent magnetism

Parameters

Model	Rated Load (kg)	Packing (mm)	Max. Pull-out Force(kg)	N. W(kg)	G.W(kg)
JG-100	100	250*160*160	300	3	4
JG-200	200	280*160*150	600	5	6
JG-400	400	320*200*170	1200	10	11
JG-600	600	370*230*210	1800	20	22
JG-1000	1000	430*280*240	3000	37	40
JG-2000	2000	520*300*310	5000	68	74
JG-3000	3000	600*300*310	7500	87	93
JG-4000	4000	680*300*410	10000	113	121
JG-5000	5000	730*400*480	12500	198	213

PLM



Permanent Magnetic Lifter

- Non-slip operation lever
- Nickel plating, longer service life
- Laborsaving rotation shaft for convenient operation
- Strong permanent magnetism to guarantee concentrated and steady magnetic power
- Wide ranges of use in metal production, mining, transportation, port and pier.

Parameters

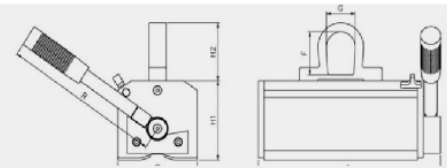

Model	Paied IIII capcc(kg)		Shape size(mm)							Weight
	钢板	圆钢	L	B	H1	H2	R	F	G	
	mm	mm	mm	mm	mm	mm	mm	mm	mm	kg
PLM-100	100	50	137	62	66	45	120	32	21	3.5
PLM-300	300	150	199	90	95	68	175	50	38	11
PLM-600	600	300	263	115	107	78	225	58	42	21
PLM-1000	1000	500	303	150	140	88	266	64	50	42
PLM-1500	1500	700	348	166	156	102	336	76	56	65
PLM-2000	2000	1000	394	175	170	102	343	76	56	83

JG2



Automatic

Permanent Magnetic Lifter

- Wide range of use in shipbuilding, machinery, moulding industry
- Automatic lifting without manual operation
- Safe operation with no electricity
- High qualified permanent magnetic material
- Patented magnetism circuit design, zero remanence
- Available for individual and combined operation, high production proficiency

Parameters

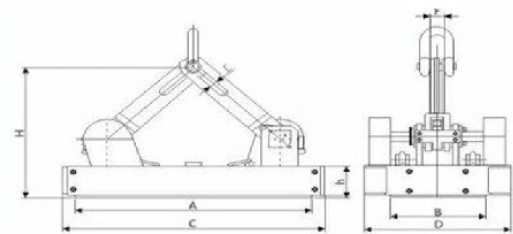

Model	Rated Load (kg)	Dimension(mm)								Max. Pull-out Force(kg)	Weight (kg)
		A	B	C	D	E	F	G	H		
JG2-1	1000	685	238	770	410	28	48	128	415	4000	193
JG2-2	2000	756	328	809	500	28	48	128	440	7000	294
JG2-3	3000	862	394	926	580	36	58	156	480	10500	380
JG2-5	5000	1018	424	1082	610	38	62	156	580	15000	490



PALLET TRUCK & FORKLIFT STACKER

HAND HYDRAULIC PALLET TRUCK



- Three-position control operation handle
- Welded pump, oil return device and safety relief valve
- Strengthen frame with high balance
- Manual hydraulic pump to achieve adjustable lowering speed
- Optional wheel material, nylon, polyurethane, steel
- Steady performance, convenient operation, flexible running, pure manually-operated without spark or electromagnetic

Parameters

Model	Welded 2T	Welded 3T	Integrated 3T	Integrated 5T
Rated Load (kg)	2000	3000	3000	5000
Min. Height (mm)	85	85	85	90
Max. Lifting Height (mm)	200	200	200	200
Steering Wheel (mm)	180*50	180*50	180*50	180*50
Fork Wheel (mm)	80*70	80*70	80*70	80*68
Overall Height(mm)	1220	1220	1220	1240
Overall Length(mm)	1560	1560	1560	1600
Nominal Length (mm)	1200	1200	1200	1200
Nominal Width (mm)	550	685	550/685	685
Fork Size W*H (mm)	150/55	160/65	160/65	180/65
Weight (kg)	55	70	68/72	140
Ground Clearance (mm)	25	15	15	25
Overall Dimension	2270*550*620	2360*685*610	2260*550*630/ 2260*685*610	2000*685*550
Wheel Material	Nylon/PU	Nylon/PU	Nylon/PU	Nylon/PU



HYDRAULIC FORKLIFT STACKER

- Non-slip handle, extended foot pedal, human oriented for safety and convenience
- Premium pump, reinforced chain, wider rubber wheel
- Mini structure for wide usage in cargo loading, short-range transport in orchard, depot, markets
- Light weight, portable, easy operation, compact appearance, strong frame with long performance life



Parameters

Model	Hydraulic Forklift Stacker	Unit
Rated Load	200	kg
Lifting Height	900	mm
Stacker Height	1250	mm
Stacker Width	730	mm
Stacker Length	750	mm
Fork Length	470	mm
Fork Width	75	mm
Min. Fork Width	150	mm
Fork Inner Width	360	mm
Fork Outer Width	510	mm
Front Wheel Size	2.62	Inch
Rear Wheel Size	11.79	inch
Leg Width	50	mm
Leg Length	470	mm
Leg Inner Width	400	mm
Leg Outer Width	500	mm
Min. Fork Height	60	mm
Max. Fork Height	910	mm
Moving Type	Straight or cant push	
Turning	cant	
Weight	36	kg



PALLET TRUCK & FORKLIFT STACKER

UNIVERSAL WHEEL HYDRAULIC STACKER



- Extended foot Pedal, human oriented
- Premium pump, reinforced chain
- Seamless pipe for fork shaft with plating technique
- Mini structure and light weight for portable usage, easy operation, compact appearance, strong frame with long performance life



Parameters

Model	Universal Hydraulic Stacker			Unit
Rated Load	200	400	400	kg
Lifting Height	900	900	1600	mm
Stacker Height	1160	1160	1900	mm
Stacker Width	590	620	620	mm
Stacker Length	750	1100	1100	mm
Fork Length	470	650	650	mm
Fork Width	75	100	100	mm
Min. Fork Width	150	220	220	mm
Fork Inner Width	360	380	380	mm
Fork Outer Width	510	600	600	mm
Front Wheel Size	2.62	3.93	3.93	inch
Rear Wheel Size	6.55	6.55	6.55	inch
Leg Width	50	50	50	mm
Leg Length	470	630	630	mm
Leg Inner Width	400	400	400	mm
Leg Outer Width	500	500	500	mm
Min. Fork Height	60	100	100	mm
Max. Fork Height	910	900	1600	mm
Moving Type	Horizontal			
Turning	Any directions			
Weight	38	60	76	kg

ROLLER HYDRAULIC STACKER



Parameters

Model	Roller Hydraulic Stacker	Unit
Rated Load	200	kg
Lifting Height	900	mm
Stacker Height	1250	mm
Stacker Width	730	mm
Stacker Length	750	mm
Fork Length	470	mm
Fork Width	105	mm
Min. Fork Width	230	mm
Fork Inner Width	300	mm
Fork Outer Width	510	mm
Front Wheel Size	2.62	inch
Rear Wheel Size	11.79	inch
Leg Width	50	mm
Leg Length	470	mm
Leg Inner Width	400	mm
Leg Outer Width	500	mm
Min. Fork Height	100	mm
Max. Fork Height	900	mm
Moving Type	Straight and cant push	
Turning	cant push	
Weight	45	kg

PALLET TRUCK & FORKLIFT STACKER

MANUAL HYDRAULIC STACKER



Parameters

Model	Manual Hydraulic Stacker	Unit
Rated Load	120	kg
Lifting Height	1050	mm
Stacker Height	1400	mm
Stacker Width	500	mm
Stacker Length	650	mm
Fork Length	420	mm
Fork Width	65	mm
Min. Fork Width	350	mm
Fork Inner Width	220-250	mm
Fork Outer Width	350-480	mm
Front Wheel Size	1.97	inch
Rear Wheel Size	3.93	inch
Leg Width	50	mm
Leg Length	410	mm
Leg Inner Width	260	mm
Leg Outer Width	360	mm
Min. Fork Height	90	mm
Max. Fork Height	1050	mm
Moving Type	Straight and cant push	
Turning	To the front wheel	
Weight	30	kg



PLATFORM HYDRAULIC STACKER

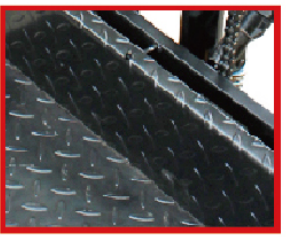

Parameters

Model	Platform Hydraulic Stacker	Unit
Rated Load	200	kg
Lifting Height	900	mm
Stacker Height	1250	mm
Stacker Width	730	mm
Stacker Length	750	mm
Fork Length	420	mm
Fork Inner Width	450*510	mm
Fork Outer Width	450*510	mm
Front Wheel Size	2.62	inch
Rear Wheel Size	11.79	inch
Leg Width	50	mm
Leg Length	470	mm
Leg Inner Width	400	mm
Leg Outer Width	500	mm
Min. Fork Height	60	mm
Max. Fork Height	900	mm
Moving Type	Straight and cant push	
Turning	To the front wheel	
Weight	38	kg



PALLET TRUCK & FORKLIFT STACKER

C TYPE STEEL MANUAL HYDRAULIC STACKER

- Heavy C-type steel for frame mast with more safety and strength
- Premium oil pump ,pollution free, flexible operation, small turn radius
- Suitable for sites of workshop, warehouse, stations, depot, airport, especially environment with strict fire and explosion-proof demands like painting site, bulk plant, chemicals storehouse

Rated Load (kg)	1000	2000
Mast Height (mm)	1980	1980
Fork Size (mm)	900*90	900*120
Fork Outer Width (mm)	200-730	260-740
Mast Ground Clearance(mm)	20	20
Overall Dimension L*W (mm)	1470*700	1470*700
Weight (kg)	160	212



DOUBLE MAST HYDRAULIC LIFT STACKER

- Light machine weight for flexible and easy operation, convenient maintenance
- Highly strengthened steel fork ,safe and reliable performance
- Firm hoisting system satisfies most lifting demands, lower control valve and overflow valve
- Flexible wheeling, sealing bearing, wearing resistance nylon wheels



Rated Load (kg)	Center Distance (mm)	Mast Height (mm)	Overall Length (mm)	Overall Width (mm)	Fork Size (mm)	Fork Outer Width (mm)	Ground Clearance (mm)
1000	450	1400/1600/	1470	700	900*90	200-730	20
2000	450	1850/2100/2450	1470	700	900*120	260-740	20
3000	450		1470	700	900*150	320-770	20

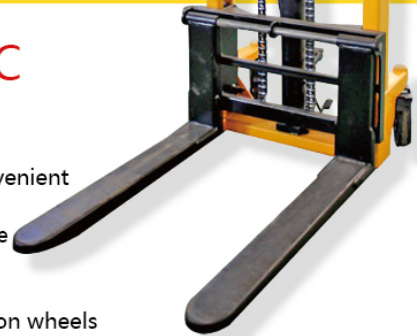

I BEAM STEEL HYDRAULIC LIFT STACKER

Parameters

Rated Load	Center Distance	Mast Height	Overall Length	Overall Width	Fork Size	Ground Clearance	Weight	Fork Outer Width
2000kg	450	2000	1470	700	830*120	20	188	260-780
3000kg	450	2000	1470	700	830*140	20	240	300-780

- 12# I beam steel for lifter mast frame, more strong, flexible and laborsaving operation
- Premium oil pump with imported oil seal and integrated valve case, pressure released by foot paddle with steady lowering speed
- Pollution free, flexible operation, small turn radius, higher efficiency



PALLET TRUCK & FORKLIFT STACKER

SEMI ELECTRIC LIFT STACKER

- U type mast fitted with braking and emergency power-off switch
- Gas spring handle with rubber coating, thickened fork steel, wide load wheels
- Comfortable operation, steady performance, low noise and environment pollution, compact structure, convenient maintenance
- Customized design as clients' require, optional polyurethane wheel available for strict ground protection demands.

SPN



Model	Unit	SPN1060/1020/ 1025/1030/1035	SPN1516/1520/ 1525/1530/1535	SPN2016/2020
Capacity	kg	1000	1000	2000
Max.Lift Height	mm	1600/2000/2500 /3000/3500	1600/2000/2500 /3000/3500	1600/2000
Lowered height	mm	85		
Load Center	mm	600		
Fork Length	mm	1150		
Fork Size	mm	150*60		
Min.Turn Radius	mm	1280		
Body Length	mm	1710		
Body width	mm	755		
Min.mast Height	mm	1980/1530/1780 /2030/2280	1980/1530/1780 /2030/2280	1980/1530
Fork width	mm	300-640		

SPM



Model	Single Frame		Double- Frame Series			
	SPM1016/ 1516/2016	SPM1020 /1520	SPM1025 /1525	SPM1030 /1530	SPM1030 /1535	SPM2020
Rated Capacity(kg)	1000/1500/2000	1000/1500	1000/1500	1000/1500	1000/1500	2000
Load Center(mm)	400	400	400	400	400	400
Max.Fork Height(mm)	1600	2000	2500	3000	3500	2000
Max.Machine Height(mm)	2010	2560	3060	3560	4060	2560
Fork Size(mm)	1150*160					
Fork Width(mm)	Adjustable width(340-760)/fixed width(540)					
Outer Width of Front leg(mm)	630/490					
Overall Size L*W*H(mm)	1660*800*2060	1660*800 *1580	1660*800 *1830	1660*800 *2080	1660*800 *2330	1660*800 *1580
Weight(kg)	365-390	425	450	470	500	470

ELECTRIC LIFT STACKER

- Electricity driven moving, hoisting, turning, step-less speed control
- Advanced control system, programmed functions setting
- Main elements adopt original or imported material, like electric controlling system, pump assembly, driven unit
- Optional tow or three section mast, double hydro cylinder, more steady operation
- Double mast model, chain transmission, complete safety protection devices.
- Customized loads and lifting height models available as clients require

Parameters

Rated Load(kg)	1000	1500	2000
Max. Lifting Height (mm)	1600/2000/2500/3000/3500		
Fork L*W (mm)	940*730		
Min.Turn Radius (mm)	1720		
Handle Height (mm)	1300-1500		
Driven Motor (v/kw)	24/1.5		
Hoisting Motor (v/kw)	24/1.2		
Battery (v/Ah)	24/210		
Charger (v/A)	24/20-30		
Overall L*W (mm)	1850*790		
Overall Height (mm)	2710/1630/1900/2170/2560/2560		
Weight (kg)	450		





HAND WINCH

IRON Hand Winch

Parameter see FORM A

- Self-braking system, safer and more convenient operation
- Qualified carbon steel for gear parts with higher wearing and ductility
- Small size for portable usage in various work sites and environment
- Comfortable manual operation without electricity drive
- Automatic braking works when the roller holds while loaded
- Wide usage in home transport, loading and staff , car hauling, etc.



FORM A

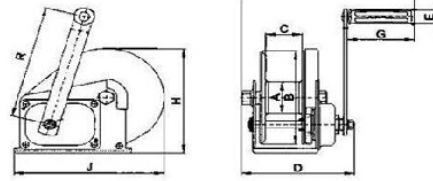

Model	Rated Load (lbs)	Cable lift (mm*m)	Size(mm)						Net Weight (kg)
			A	B	C	D	H	L	
CDL 1200	1200	4*35	88	50	45	136	155	138	3.8
CDL 1800	1800	5*50	107	60	50	181	198	193	8.0
CDL 2600	2600	5*50	127	62	60	181	210	240	10.2

Stainless Steel Hand Winch

Parameter see FORM A

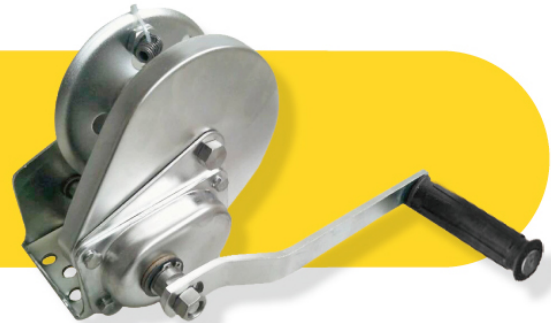
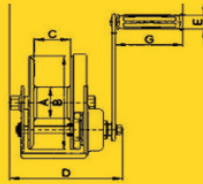

- 1.Light volume, portable for various work sites
- 2.Compact and firm structure, qualified carbon steel for gears and core elements
- 3.Automatic brake system, higher safe factor with load always stays at the required scale whenever release the handle
- 4.Friction stopping device with automatic dual braking and self-locking elevating while loaded
- Available in various hoisting and hauling work sites, confined spaces, tough environment, pure manual operation without electricity drive.

Hand Winch

- More delicate and lighter, much more convenient for household usage, items moving, truck hauling
- Self-locking nut for dual fail-safe

- High snap-in force aluminum gears with laborsaving operation and higher pull-out force
- Thicken casing, wider spool spindle, wearing resistance with long performance life.

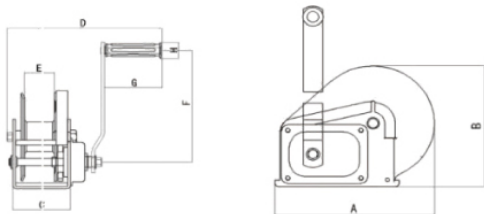
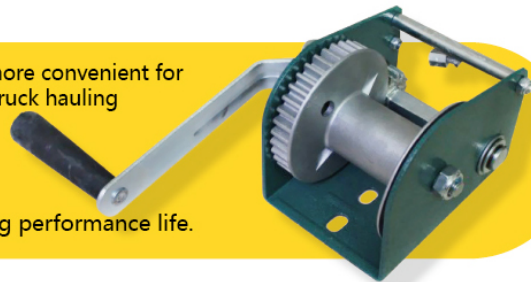

Parameters

Model	Rated Load (lbs)	Size(mm)								Net Weight (kg)
		A	B	C	D	E	F	G	H	
JG-500	1100	125	96	90	236	60	165	90	25	2.31



MINI CRANE LIFT



OUTDOOR 360 DEGREE ROTATION CRANE LIFT

- Fine appearance, pure copper motor, little noise, power saving
- Multiple combination with different motors, convenient assembly and dismantling
- Widely used in high rise building lifting projects, available mounted in huge construction site matched with scaffold
- Suitable for small constructional engineering as gantry crane and tower crane replacement

Parameters

Load	Motor Power	Wire Dia.	Work Time	Voltage	Overall Weight	Operation Speed	Motor Speed
300kg	1150W/800W	5MM	1-2h	220V/380V	70/85KG	12m/min	1200 r/min
400kg	1450W	5MM	1h	220V	75KG	12m/min	1200 r/min
500kg	2200W/1500W	6MM	1-2h	220V/380V	85/100KG	12m/min	1200 r/min
Fast-500kg	2200W/1500W	6MM	1-2h	220V/380V	86/102KG	12m/min	2400/1800 r/min

Notes:

- Usage Frequency: intermittent motor performance
- Recommended Load: 12m as standard lifting height, more wire required if above 20m and the load will be decreased respectively as 20m (75%), 25m(60%), 30m(50%)



OUTDOOR 180 DEGREE ROTATION CRANE LIFT

- Thickened seamless steel pipe, qualified bearing with thickened pulley
- Flexible and smooth bearing performance with long durable life
- Strong base with ballast to ensure whole stability

Parameters

Load	Power	Speed	Wire Diameter	Work Time
200KG(220V)	850W	12m/min	5mm	0.5-1 h
300KG(220V/380V)	1150W/800W	12m/min	5mm	1-1.5 h
400KG(220V)	1450W	12m/min	5mm	1-1.5 h
500KG(220V/380V)	2200W/1500w	12m/min	6mm	3-4h



OUTDOOR FULL ANGLE CRANE LIFT

- Easy installation and dismantling, convenient maintenance
- Full angle rotation, especially suitable for high rising building application
- Compact structure, strengthened material, copper motor, strong base, human oriented control button
- Matched with 220V braking motor, manual braking and clutch device for fast lowering
- Optional combination with 380V/220V multifunctional hoisting, 220V mini electric chain hoist

Parameters

Model	300KG	400KG
Rated Voltage (V)	220	220
Rated Power (kw)	1.6	1.8
Rated Load (kg)	300	400
Lifting Speed(m/min)	12	12
Rated Frequency (Hz)	60	60
Wire Dia. (mm)	5	5
Wire Length (m)	30	30



MINI CRANE LIFT

FOUR COLUMN CRANE LIFT

- Four column design , more stable, more loading weight
 - Thickened column steel, pure copper motor, adjustable column height, linear sliding hanger rail
 - Flexible match with electric chain hoist for short distance and intensive lifting work
 - High efficiency, power saving, small footprint, easy operation and maintenance
- Widely applied both indoor and outdoor with satisfying performance

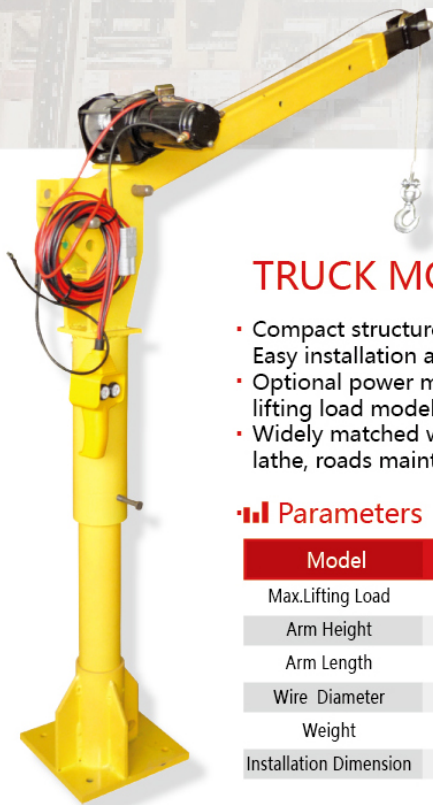

TRUCK MOUNTED MINI CRANE LIFT

- Compact structure, small footprint, light weight
- Easy installation and operation, convenient portable body
- Optional power motor 12V, 24V, 220V and 500kg, 1000kg or customized lifting load models
- Widely matched with truck, trailer, rescue vehicle and used in bridgework, lathe, roads maintenance sites

Parameters

Model	PH500
Max.Lifting Load	500KG (commonly load as 300kg)
Arm Height	Adjustable from 1.1m-2.2m
Arm Length	Adjustable with three-position pin eye
Wire Diameter	5mm, 4.5m length(12m for 220V)
Weight	62KG
Installation Dimension	250mm*250mm*18mm

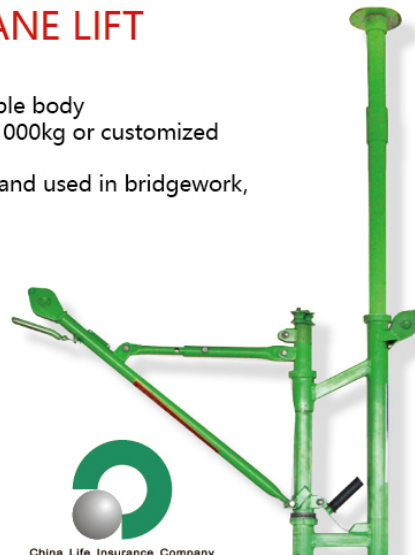

China Life Insurance Company

Parameters

Rated Load	300KG	400KG	500KG	500KG--FAST
Rated Voltage	220V/50HZ			
Rated Power	1.5KW	1.8KW	2.2KW	2.2KW
Lifting Speed	12m/min	12m/min	12m/min	20m/min
Weight	65KG	68KG	80KG	80KG
Installation Height	2.6-3.2m	2.6-3.2m	2.6-3.2m	2.6-3.2m
Max. Stretch Length	1.1m	1.1m	1.1m	1.1m
Min. Window Width	0.6m	0.6m	0.6m	0.6m
Common Lifting Load	150KG	200KG	250KG	200KG
Max. Lifting Height	27m	27m	27m	27m

INDOOR FOLDING CRANE

- Compact structure, small footprint, conveniently portable, pure copper motor
- Insured by China Life Insurance Company
- Strong and durable with alloy steel support
- Pure copper motor with high power but little noise
- Especially suitable for small window application

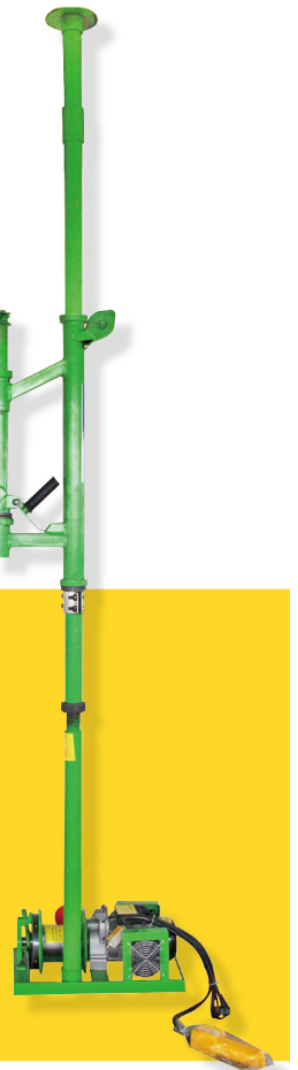



MINI CRANE LIFT

INDOOR COLUMN SUPPORT CRANE

- Light weight, portable, integrated structure, (double column crane available as required)
- 360 degree rotation lifting arm, adjustable height
- Strengthened round steel column, G80 lifting chain, clutch with drop-off proof device, copper motor
- Optional multifunctional crane while combined support bracket

Parameters

Model	300KG	400KG	500KG
Rated Load (kg)	300	400	500
Lifting Speed (m/min)	12	12	12
5mm Wire Length (m)	30	30	30
Rated Voltage	220V/50Hz		
Rated Power (kw)	1.5	1.8	2.2
Installation Height (m)	2.6-3.1	2.6-3.1	2.6-3.1
Net Weight (kg)	65	68	82
Package	Paper box or customized		



Rated Load	300KG	400KG	500KG
Rated Voltage	220V/50Hz	220V/50Hz	220V/50Hz
Rated Power	1.5KW	1.8KW	2.2KW
Lifting Speed	12 m/min	12 m/min	12 m/min
Weight (Single wire/double wire)	95KG/118KG	97KG/120KG	110KG/130KG
Installation Height	2.6-3.1m	2.6-3.1m	2.6-3.1m
Max. Stretch Length out of window	1.5m	1.5m	1.5m
Min. Retract Length inside the window	0.1m	0.1m	0.1m
Min. Window Width	0.35m	0.35m	0.35m
Common Lifting load (Single wire/double wire)	200KG/280KG	300KG/380KG	400KG/480KG
Max. Lifting Height	27m	27m	27m

INDOOR LINEAR SLIDING CRANE

- Light weight, small volume, integrated structure, portable for bicycle
- Strengthened steel pipe combination, double wire design, adjustable column height
- Fast lifting speed, 1 meter in 4 seconds, one round within 3 minutes for 10th floor
- Easy operation, convenient installation within 5 minutes, steady and reliable performance
- Both indoor and outside installation available, small construction project application replacement.

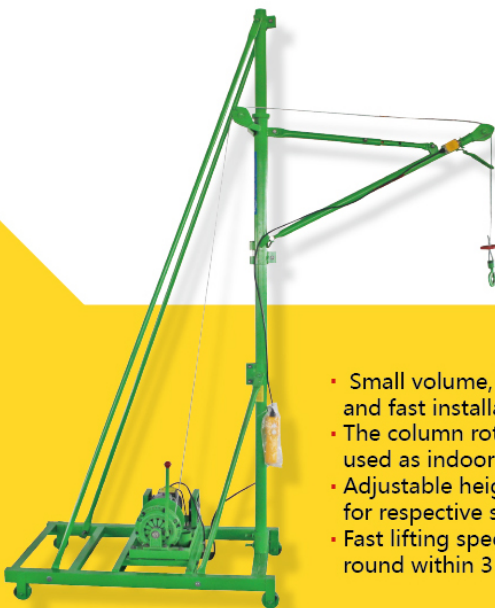

INDOOR MOBILE MULTIFUNCTIONAL CRANE

- Small volume, light weight, compact structure, easy and fast installation,
- The column rotation arm could be independently used as indoor single column crane
- Adjustable height for various applications and loads for respective size window
- Fast lifting speed of one meter in 4 seconds, one round within 3 minutes for 10th floor height.

Parameters

Model	300KG	400KG	500KG
Weight	90KG	92KG	110KG
Voltage	220V/50HZ		
Power	1.5KW	1.8KW	2.2KW
Wire Length	30m	30m	30m
Wire Diameter	5mm	5mm	6mm



Hebei Jingong Machinery Co., LTD

☎ 0312-8151268

📧 jingong@jingongjx.com

📍 Donglv Industrial, Qingyuan Country, Hebei Province, China.

